

LIVING ROOM
17'-4" x 14'-0"

KITCHEN
8'-6" x 9'-3"

DINING ROOM
10'-9" x 15'-5"

HALL

FOYER

CLO

LANDING

UP

DN

BATH #2

W
D

BROOKSHIRE
20'-0" X 40'-0"
1,578 TOTAL Sq. Ft.

BEDROOM #1
12'-0" x 19'-1"

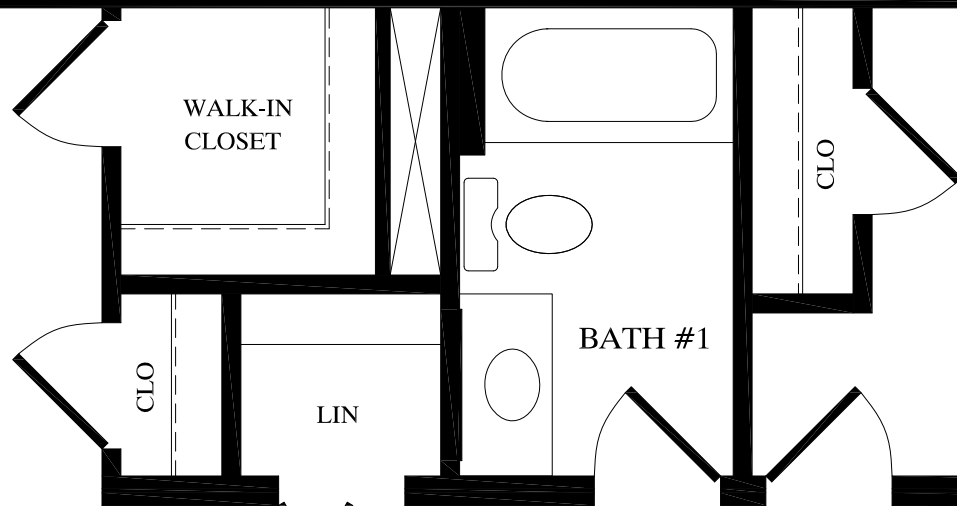

BEDROOM #3
11'-9" x 9'-3"

HALL

BEDROOM #2
10'-2" x 9'-3"

